



# SALA AMARONE

370 sqm  
26,4 x 14 x h 4,20 m

## CAPACITY AND LAYOUT

Theatre

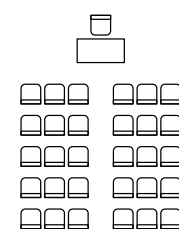

400

U-shape

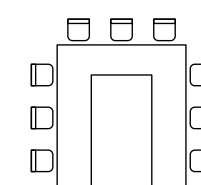

/

Classroom

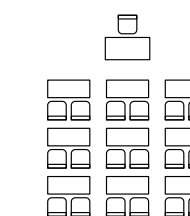

150

Cabaret

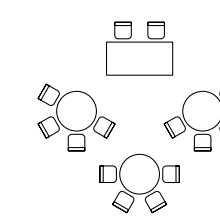

144

Board

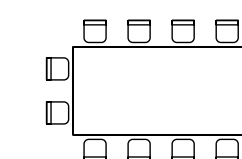

/

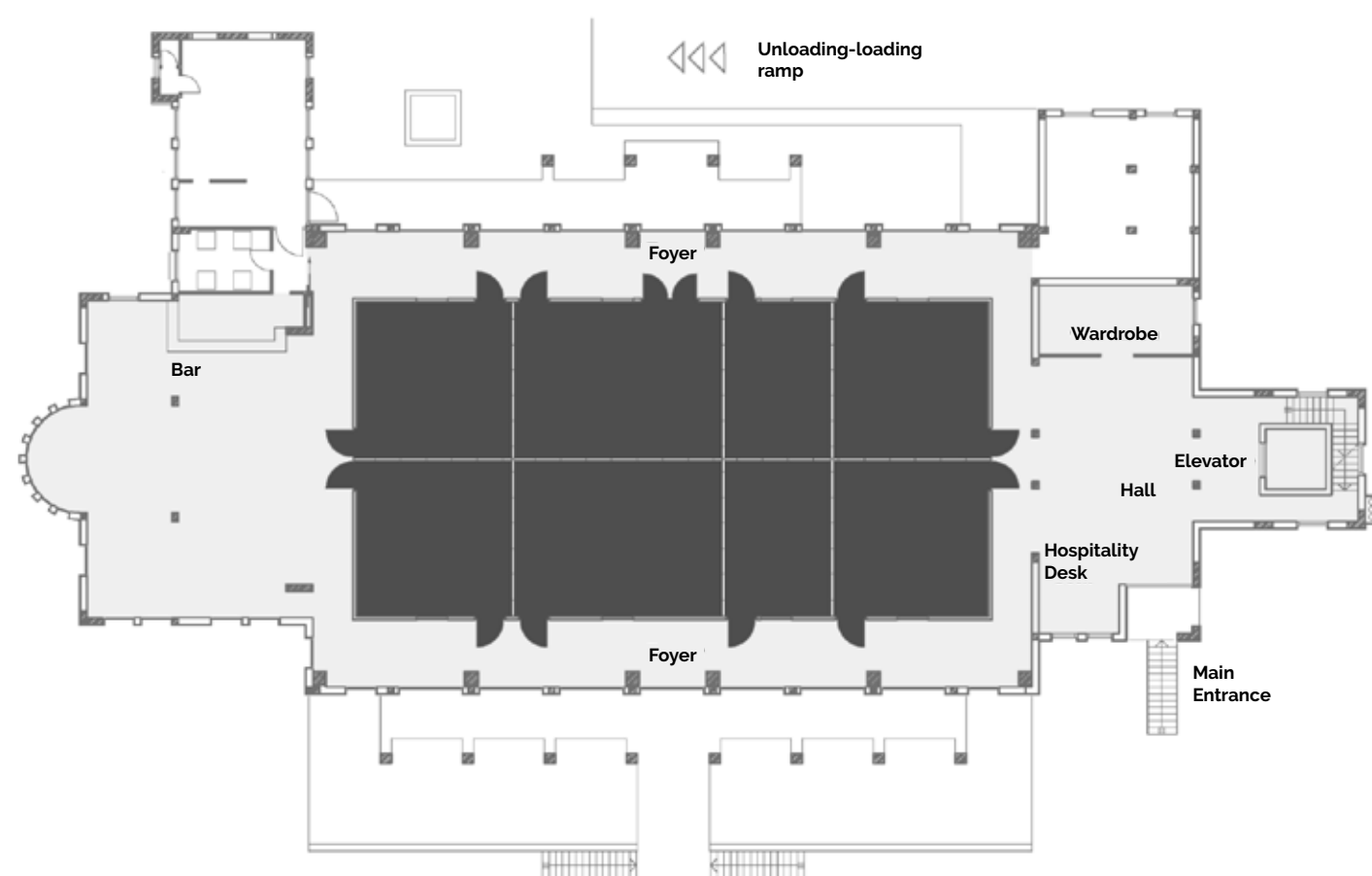

## EQUIPMENTS

### Wi-Fi

- fiber optic up to 100 Mbps

### Audio Video

- 2 motorized ceiling screens 3,6x2,7 m
- 2 ceiling laser projectors 6200 Lumen (FULL HD - Resolution WUXGA)
- 2 additional ceiling screens 2,9 x 2,1 m (comfort monitors for the participants)
- 2 ceiling laser projectors 6000 Lumen (FULL HD - Resolution WUXGA)
- touch control panel for sound and video system

### Additional equipments

- stage 7x2 m - height 25 cm; lectern; flipchart
- laser pointer; direct phone line in room

### Access

- access ramp for loading and unloading

### Upon request

- video conference and simultaneous translation