



# SALA RIPASSO

105 sqm  
15 x 7 x h 4,20 m

## CAPACITY AND LAYOUT

Theatre

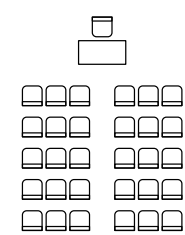

90

U-shape

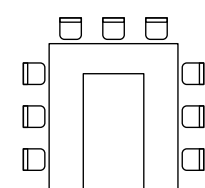

34

Classroom

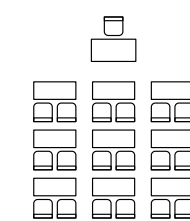

48

Cabaret

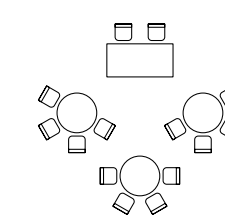

36

Board

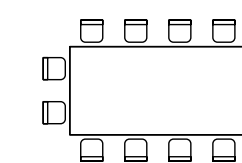

40

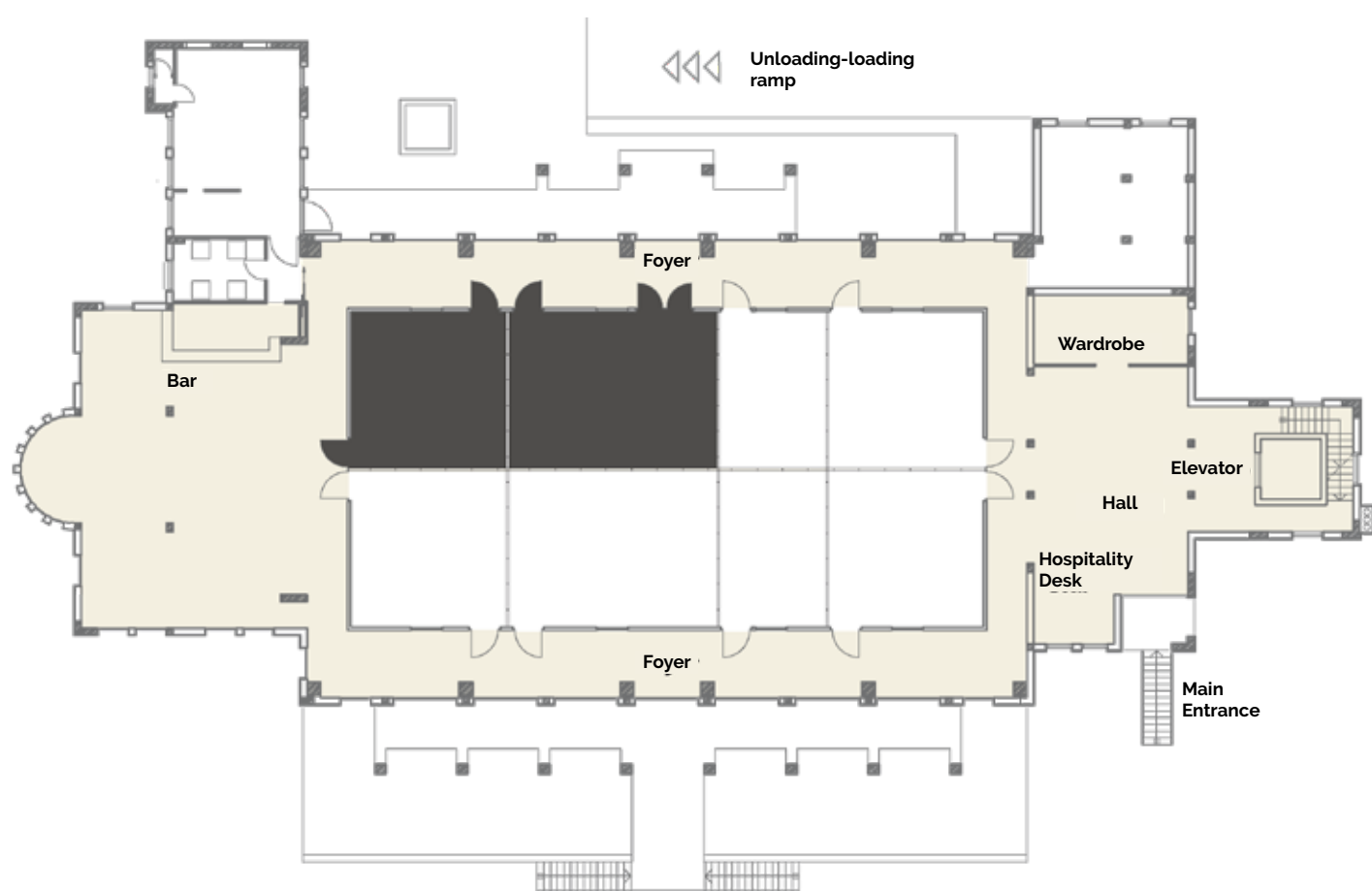

## EQUIPMENTS

### Wi-Fi

- fiber optic up to 100 Mbs

### Audio Video

- motorized ceiling screen 3,6x2,7 m and ceiling laser projector 6200 Lumens ceiling
- screen 2,9 x 2,1 m at the end of the meeting room (comfort monitors for presenter)
- touch control panel for sound and video system

### Additional equipments

- flipchart; laser pointer; direct phone line in room

### Access

- access ramp for loading and unloading

### Upon request

- video conference and simultaneous translation